

JUMEIRAH BEACH RESIDENCE



Beachside Living In The City

Jumeirah Beach Residence (JBR) at the waterfront is a community consisting of 36 residential towers, four hotels situated above The Walk.



A COMMUNITY BY

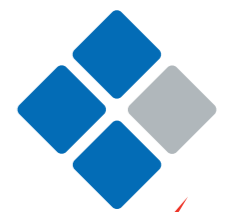

DUBAI
PROPERTIES GROUP



JUMEIRAH BEACH RESIDENCE

Beachside living from AED 900/sq. ft.

Jumeirah Beach Residence Overview

The waterfront community of Jumeirah Beach Residence (JBR) has fast become Dubai's most dynamic address consisting of 36 residential towers, four hotels, and situated above The Walk, Dubai's only beachfront retail and dining destination. JBR is the perfect choice for investors and homeowners alike.

The development offers a wide selection of residential units ranging from studio, one, two, three, and four bedroom apartments with sea and marina views to suit different budgets and requirements. This uniquely-themed environment combines both Mediterranean and local architecture, complimented by landscaped plazas, kids' play areas, fountains and courtyards.

Key features:

- Beachfront setting in Jumeirah Beach, Dubai's prime resort district
- Home to The Walk, Dubai's only beachfront retail and dining destination
- Easy access to Shaikh Zayed Road, Dubai Metro
- Community facilities including swimming pools and landscaped plazas
- Full on-site services including nurseries, medical centers, spas, gym and prayer rooms

Location map:

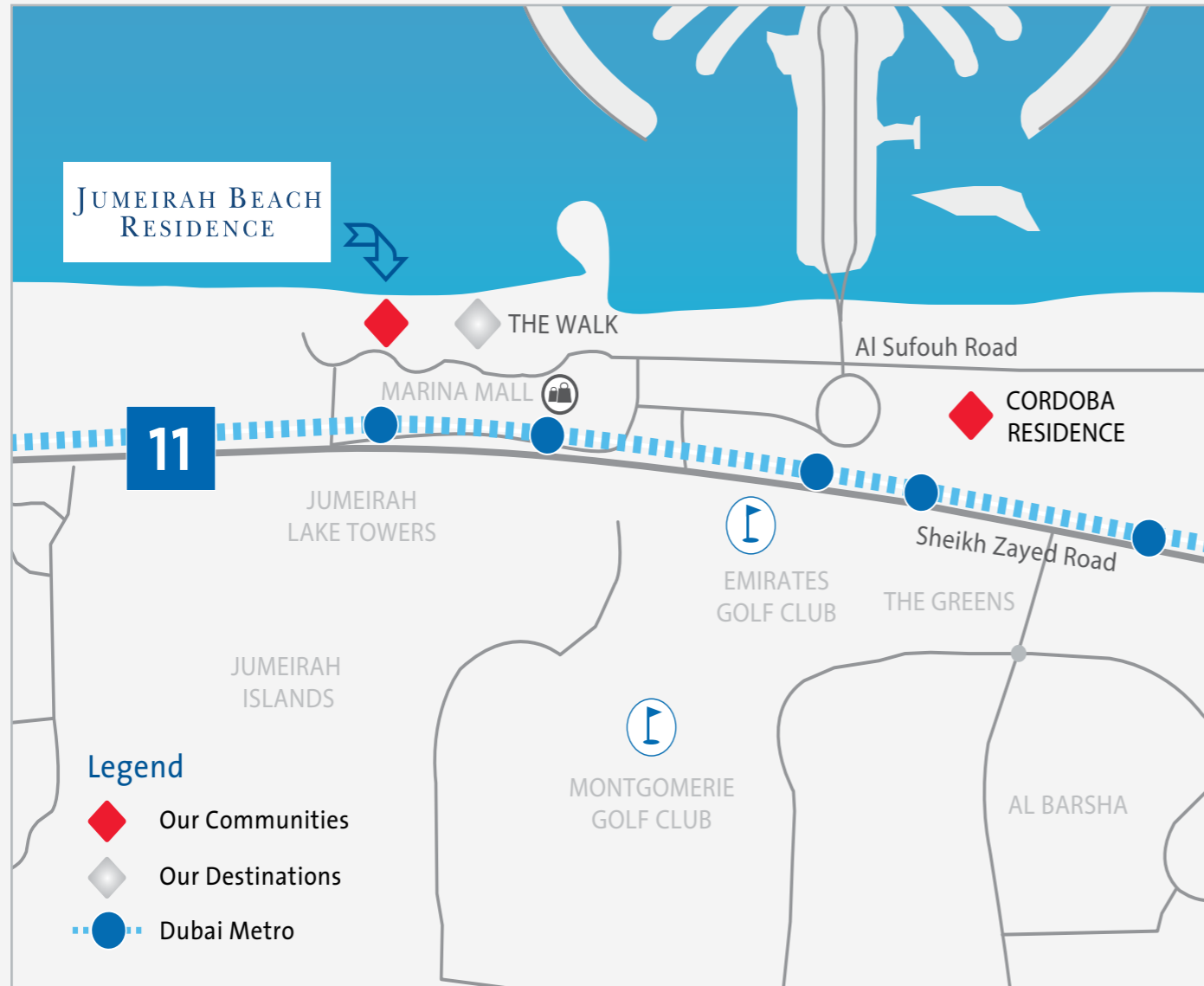

Available units:

Unit Type	Unit Area (sq.ft.)
1 Bedroom	1,105.6 to 2,356
2 Bedroom	1,405.4 to 1,827.3
3 Bedroom	1,797.39 to 3,145.8
4 Bedroom	2,534 to 6,306.8
Terrace Apartment	1,827.3
Lofts	1,844.3 to 2,356
Penthouses	6,192.3 to 6,306.8

FOR SALES ENQUIRIES

 **800DPG**



click to submit
your enquiry

JUMEIRAH BEACH RESIDENCE

A COMMUNITY BY



DUBAI
PROPERTIES GROUP

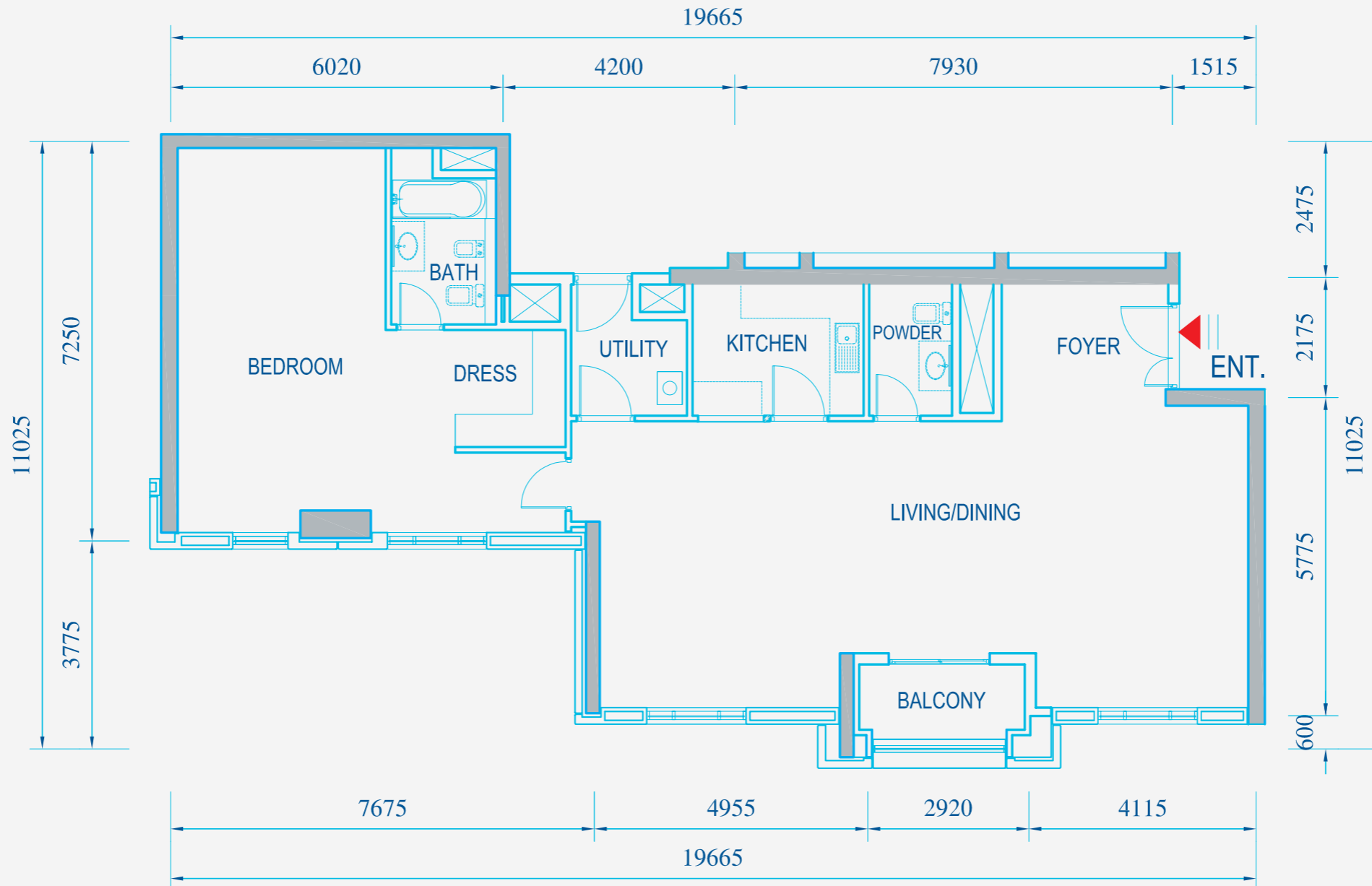

***DETAILS:**

Flat Area: 1423.0 sq. ft.
Total Area : 1465.9 sq. ft.

Balcony Area: 42.9 sq. ft.
Parking Allocation: B201

* Floor plans are for illustrative purpose only and may differ based on inventory availability.

FOR SALES ENQUIRIES
800DPG

 **click to submit your enquiry**

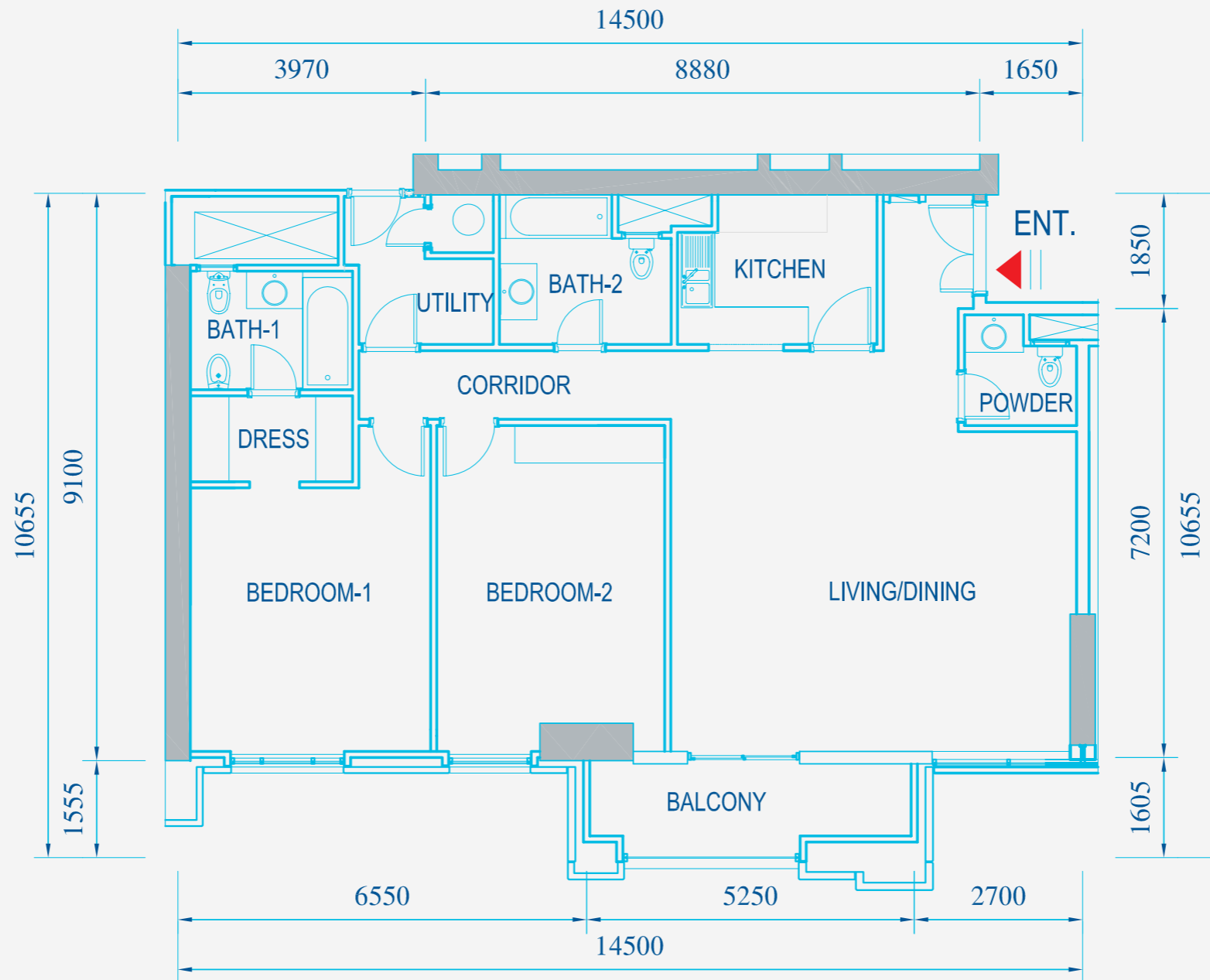

***DETAILS:**

Flat Area : 1332.5 sq. ft.

Total Area : 1405.4 sq. ft.

Balcony Area: 72.9 sq. ft.

Parking Allocation: B691

* Floor plans are for illustrative purpose only and may differ based on inventory availability.

FOR SALES ENQUIRIES

800DPG

**click to submit
your enquiry**

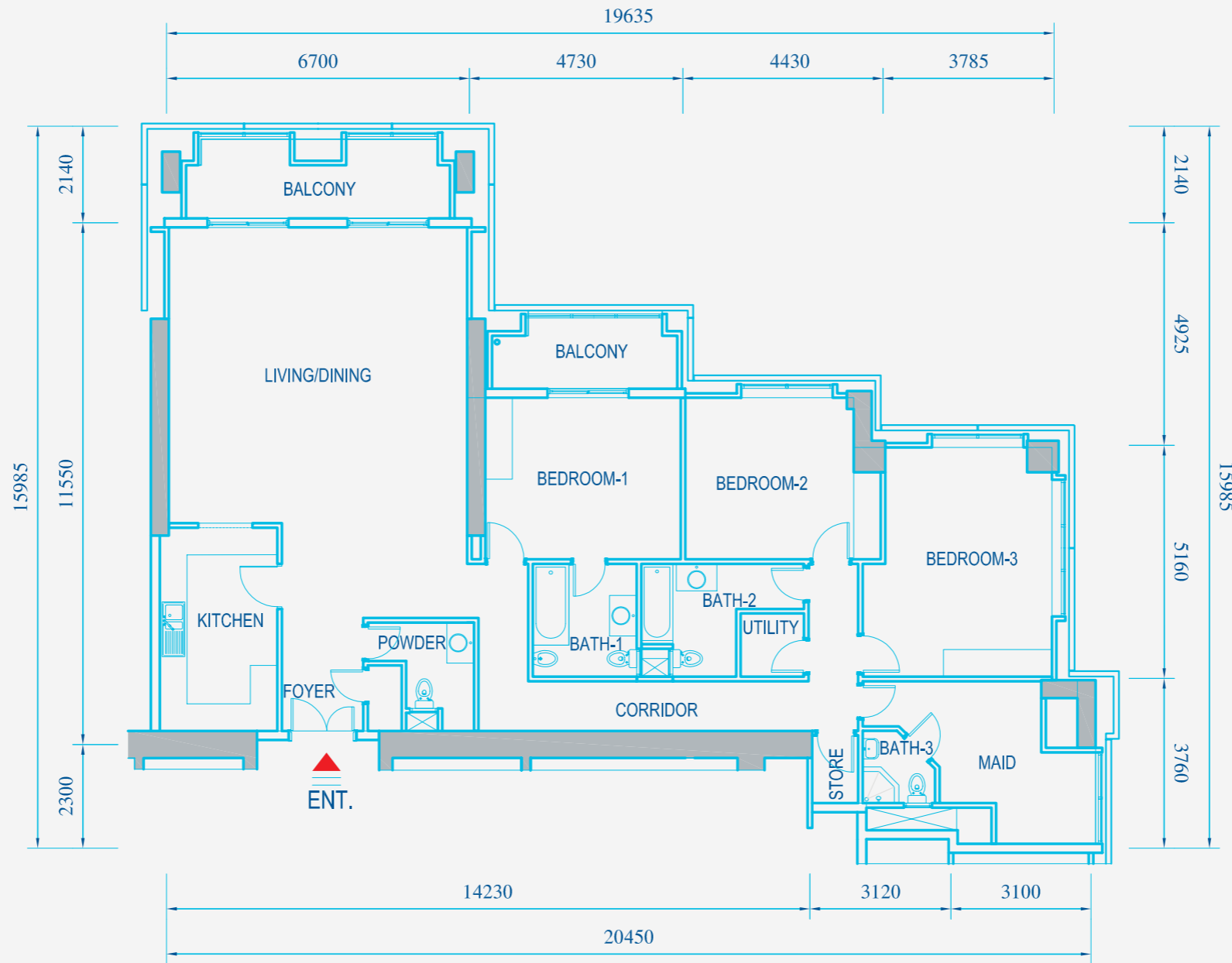

***DETAILS:**

Flat Area : 1932.0 sq. ft.

Total Area : 2093.5 sq. ft.

Balcony Area: 161.5sq. ft.

Parking Allocation: G207

* Floor plans are for illustrative purpose only and may differ based on inventory availability.

FOR SALES ENQUIRIES
 **800DPG**

 **click to submit your enquiry**

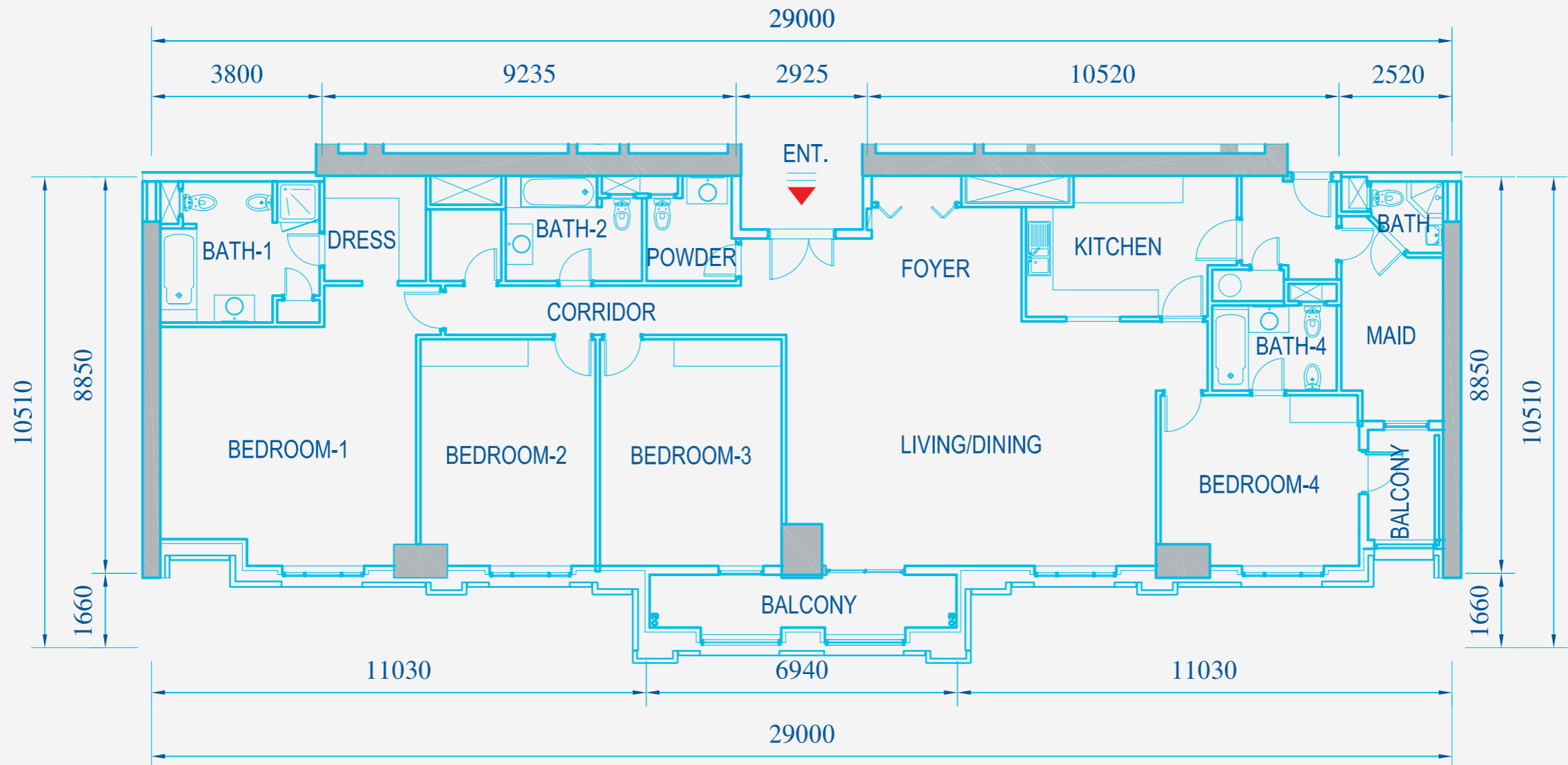

***DETAILS:**

Flat Area : 2581.6 sq. ft.

Total Area : 2673.9 sq. ft.

Balcony Area: 92.3 sq. ft.

Parking Allocation: B279/280

* Floor plans are for illustrative purpose only and may differ based on inventory availability.

FOR SALES ENQUIRIES

800DPG

**click to submit
your enquiry**

FOR SALES ENQUIRIES

 **800DPG**

 **click to submit
your enquiry**

**JUMEIRAH BEACH
RESIDENCE**

A COMMUNITY BY



**DUBAI
PROPERTIES GROUP**